

TRI-COUNTY ELECTRIC COOPERATIVE, INC.

Your Touchstone Energy® Partner 

Drawings and Specifications for ELECTRIC SERVICE

www.tri-countyelectric.net

“Owned by Those We Proudly Serve”

TRI-COUNTY ELECTRIC COOPERATIVE, INC.

Chartered in 1940, Tri-County Electric Cooperative, Inc., is a nonprofit member owned electric utility that serves more than 18,000 members in Calhoun, Orangeburg, Richland, Lexington, Sumter, and Kershaw Counties. Tri-County's service area runs just east of Columbia in Kershaw County to southern Orangeburg county near Holly Hill.

Tri-County has three conveniently located office. The main headquarters office is located on Hwy. 176 just outside of St. Matthews. The Richland District Office is located on Hwy. 378, 1 mile west of Hwy. 601. The Santee District Office is located on Hwy. 6, 1 mile east of the town of Santee. Each office is open Monday through Friday from 8:00 am to 5:00 pm for member's convenience.

St. Matthews

P.O. Box 217
6473 Old State Road
St. Matthews, SC 29135-0217

Santee

6348 Old #6 Highway
Santee, S.C. 29142-0367

Eastover

11335 Garners Ferry Rd.
Eastover, SC 29044-0398

Table of Contents

Welcome.....	2
Procedures.....	3
County Contact Numbers.....	4
Temporary Service.....	5
Temporary Underground Service.....	6
Residential Overhead.....	7
Residential Underground.....	8
Mobile Home Overhead.....	9
Mobile Home Underground.....	10
Mobile Home Underground.....	11
Residential.....	12

Dear Member-Owner

Welcome to Tri-County Electric Cooperative. Whether this is a new service for you or you already have an account with us and moving to a new location, all of the employees are ready to properly and conveniently install your electric meter.

This information booklet has been prepared to show the proper way to install an electric meter either on a site built home or a mobile home. This information is based on the current National Electric Codes (NEC) and local codes. These codes have been developed to protect your residence and for the safety of anyone who may come near the electric lines.

Should you or a contractor have a question concerning any of these requirements or drawings, please feel free to contact the district-office in your service area.

Again, welcome to Tri-County Electric Cooperative and should you have a question or comment about the service you are receiving please give us a call.

**Sincerely,
Tri-County Electric Cooperative, Inc.**

Items We Need From You:

1. A signed application and payment of a \$5.00 membership fee.
2. Security Deposit. Amount depends on type of service.
3. A request for a Tri-County Electric Cooperative, Inc. employee to mark the location of the meter base.
4. All right-of-way estimates to allow access to your property.
5. An electrical release and permit number from the county, where service is to be located.

What You Can Expect From Us:

1. After the meter base is set, you must contact the county inspector.
2. A county inspector will inspect the service and issue an electrical release before electricity can be connected.
3. Right-of-way will be acquired and cut, if needed. Then the line will be built.
4. Under normal circumstances, your service should be completed within 5 to 7 business days, if the above requirements are met.

County Contact Numbers

Calhoun County

Tax Assessor..... (803) 874-3613
Building Inspector.....(803) 874-4201

Orangeburg County

Building Inspector.....(803)533-6173
Tax Assessor.....(803) 533-6220

Lexington County

Building Inspector.....(803) 785-8130

Richland County

Building Permits and Office Inspections(803) 576-2141
576-2140

Kershaw County

Planning and Zoning.....(803) 425-1500 ext.342

Other Important Numbers

Santee Town Hall..... (803) 854-2152
Vance Town Hall.....(803) 492-3114

TEMPORARY SERVICE

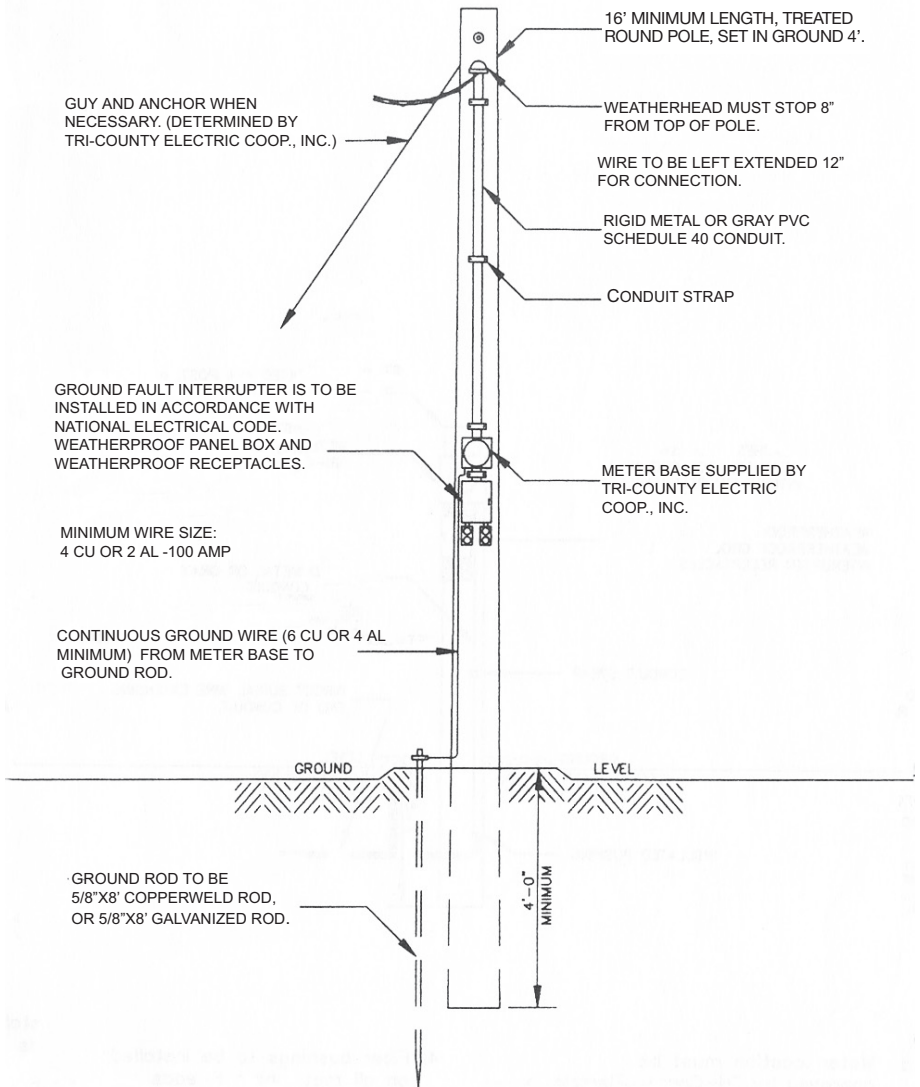

1. Meter location must be approved by Tri-County Electric Cooperative, Inc.
2. Wiring shall comply with the latest edition of the National Electric Code and all applicable local codes.
3. Center of meter base to be located 5'-0" above ground level.

4. Minimum Wire Sizes:
100A.: 4 CU or 2 AL
5. Fiber bushings to be installed on all metal pipe threads.

TEMPORARY UNDERGROUND SERVICE

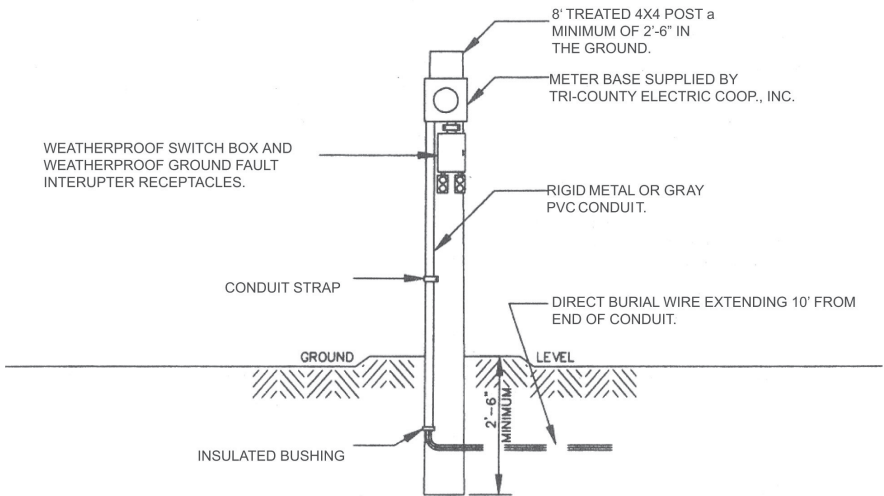

1. Meter location must be approved by Tri-County Electric Cooperative, Inc.
2. Wiring shall comply with the latest edition of the National Electric Code and all applicable local codes.
3. Center of meter base to be located 5'-0" above ground level.
4. Fiber bushings to be installed on all metal pipe threads.
5. Minimum wire size:
50 A. : 6 CU or 4 AL
6. Tri-County Electric Coop., Inc. will set owners temporary service poles.

RESIDENTIAL OVERHEAD (TO INCLUDE REWIRING)

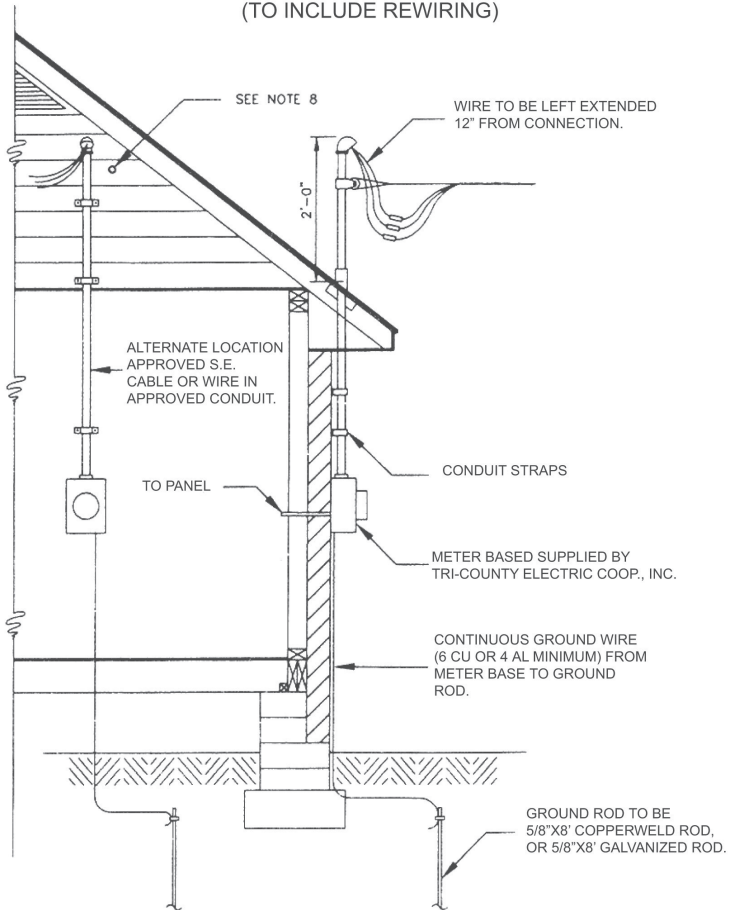

1. Meter location must be approved by Tri-County Electric Cooperative, Inc.
2. Wiring shall comply with the latest edition of the National Electric Code and all applicable local codes.
3. Center meter base to be located 5'-0" above ground level.
4. Minimum Wire Size:
100A.: 4 CU or 2 AL
200A.: 2/0 CU or 4/0 AL
5. Fiber bushings to be installed on all metal pipe threads.
6. If the weatherhead does not extend above the roof line, the owner must install a clevis (furnished by Coop). Service mast shall be 2" conduit.
7. Weatherhead must have a minimum 12' ground clearance.
8. Service Mast shall be 2" (minimum) rigid Galvanized Conduit. If the mast is surface mounted, approved electrical PVC Conduit is accepted. A service clevis will be furnished by the Co-op and installed by the Electrician.

RESIDENTIAL UNDERGROUND

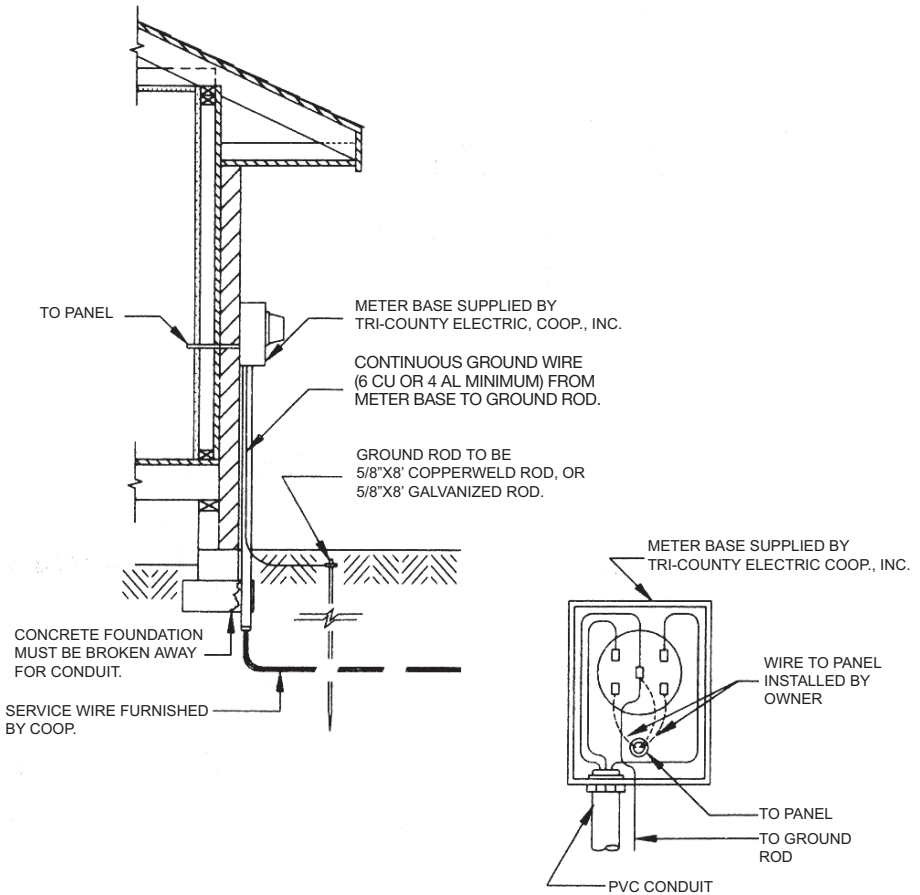

1. Meter location must be approved by Tri-County Electric Cooperative, Inc.
2. Wiring shall comply with the latest edition of the National Electric Code and all applicable local codes.
3. Center of meter base to be located 5'-0" above ground level.

4. Fiber bushings to be installed on all metal pipe threads.
5. Owner shall furnish 2 1/2" gray Schedule 40, PVC conduit for 200 Amp service or 3" gray, Schedule 40, PVC conduit for 400 Amp service, from meter base to Tri-County transformer, and (2) elbows, (2) couplings, (1) male adaptor and lock nut.

MOBILE HOME OVERHEAD (TO INCLUDE REWIRING)

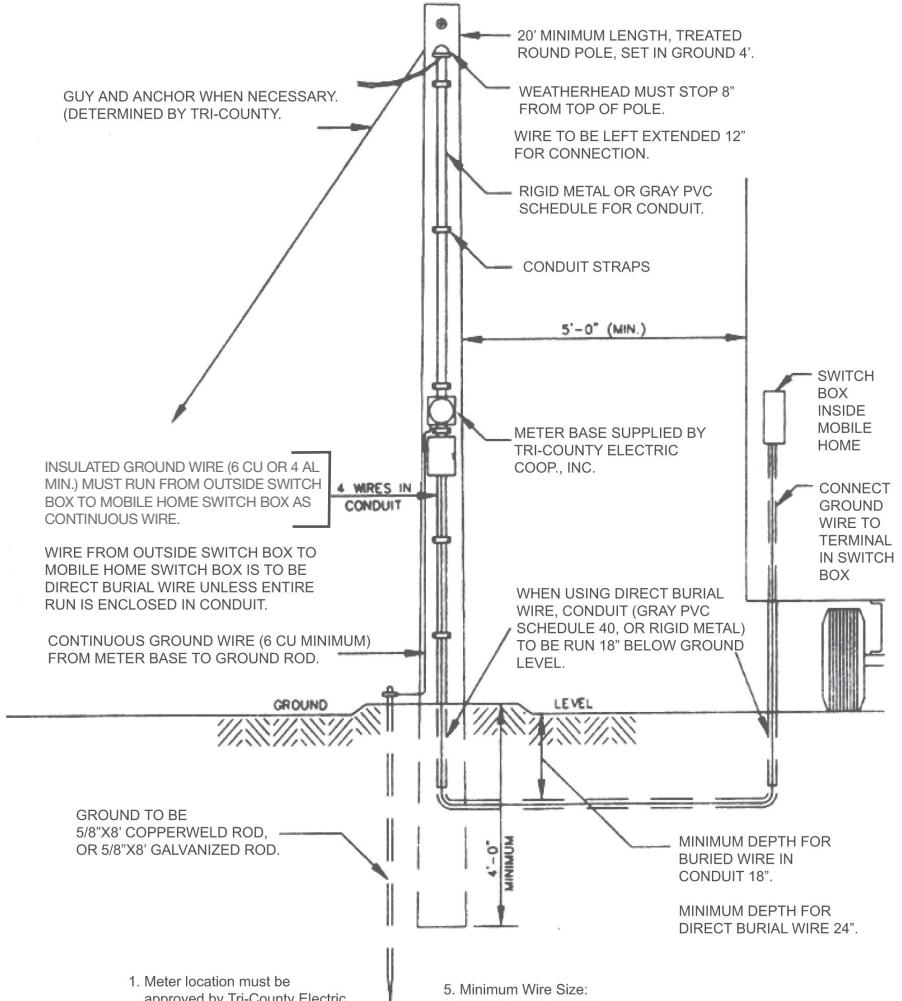

1. Meter location must be approved by Tri-County Electric Cooperative, Inc.
2. Wiring shall comply with the latest edition of the National Electric Code and all applicable local codes.
3. Center of meter base to be located 5'-0" above ground level.
4. Breaker size in outside switch box must equal main breaker size in mobile home.

5. Minimum Wire Size:
100A.: 4 CU or 2 AL
200A.: 2/0 CU or 4/0 AL
6. Fiber bushings to be installed on all metal pipe threads.
7. Owner shall install guy and anchor when necessary.

MOBILE HOME UNDERGROUND

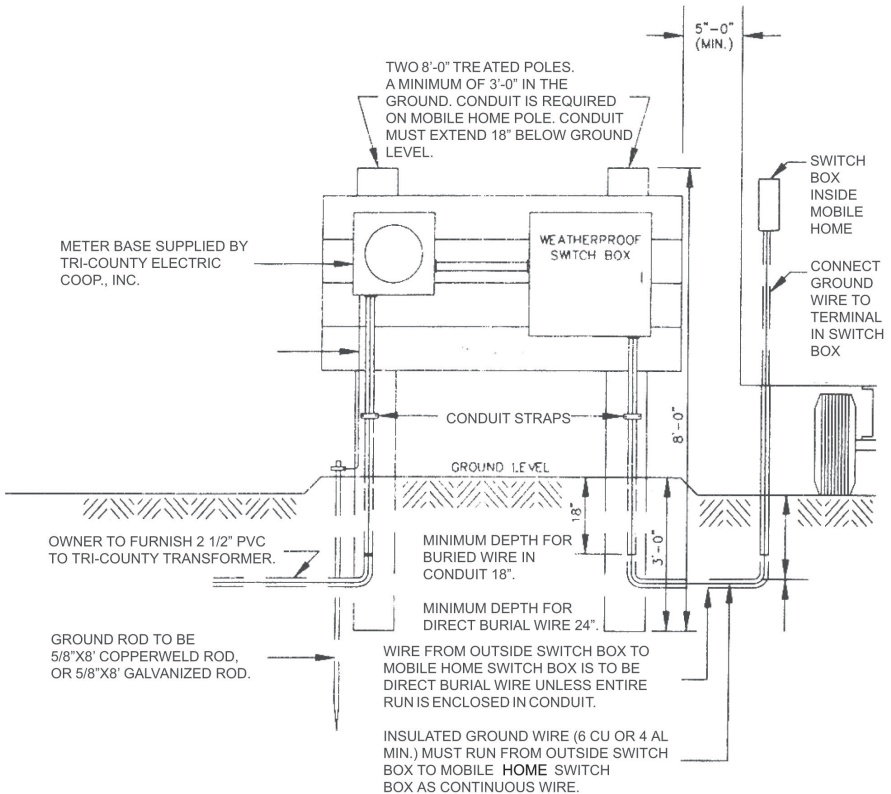

1. Meter location must be approved by Tri-County Electric Cooperative, Inc.
2. Wiring shall comply with the latest edition of the National Electric Code and all applicable local codes.
3. Center of meter base to be located 5'-0" above ground level.
4. Breaker size in outside switch box must equal main breaker size in mobile home.
5. Minimum Wire Size:
100A.: 4 CU or 2 AL
200A.: 2/0 CU or 4/0 AL
6. Fiber bushings to be installed on all metal pipe threads.
7. Owner shall furnish 2 1/2" gray Schedule 40, PVC conduit for 200 Amp service or 3" gray, Schedule 40, PVC conduit for 400 Amp service, from meter base to Tri-County transformer, and (2) elbows, (2) couplings, (1) male adaptor and lock nut.

MOBILE HOME UNDERGROUND

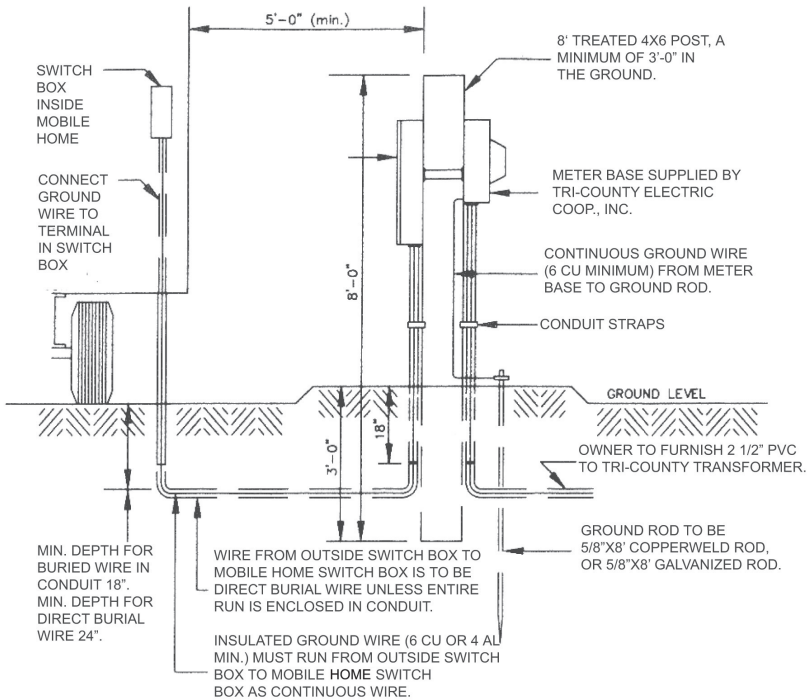

1. Meter location must be approved by Tri-County Electric Cooperative, Inc.
2. Wiring shall comply with the latest edition of the National Electric Code and all applicable local codes.
3. Center of meter base to be located 5'-0" above ground level.
4. Breaker size in outside switch box must equal main breaker size in mobile home.

5. Minimum Wire Size:
100A.: 4 CU or 2 AL
200A.: 2/0 CU or 4/0 AL
6. Fiber bushings to be installed on all metal pipe threads.
7. Owner shall furnish 2 1/2" gray Schedule 40, PVC conduit for 200 Amp service or 3" gray, Schedule 40, PVC conduit for 400 Amp service, from meter base to Tri-County transformer, and (2) elbows, (2) couplings, (1) male adaptor and lock nut.

Underground Service

Residential

200 AMP UG Service

Commercial or Large Power User

320 AMP or 400 AMP UG Service

Member will need to supply
or can be purchased from Tri-County:

1. 2 1/2" Conduit - 200 AMP Service.
2. 3" Conduit - 400 AMP Service.
3. (2) Sweeping L's
4. (2) Couplings
5. (1) Male Adaptor & Lock Nut

Tri-County Electric Cooperatives Engineering
Department will assist in determining
estimated price for underground
installation.

ST. MATTHEWS OFFICE

P.O. Box 217

6473 Old State Road

St. Matthews, S.C. 29315-0217

803-874-1214

Toll Free 1-877-874-1215

Fax 803-874-3888

EASTOVER OFFICE

11335 Garners Ferry Road

Eastover, S.C. 29044-0398

1-877-874-1215

SANTEE OFFICE

6348 Old #6 Highway

Santee, S.C. 29142-0367

1-877-874-1215